



## Spacious Split Level apartment in Emerald Park Resort complex

\$875,000 - \$930,000

Situated on the first floor overlooking the landscaped gardens of Emerald Park is this superb boutique split level apartment. Conveniently located moments to East Village Shopping Centre and Green Square train station. Superb resort style facilities with 2 swimming pools, bbq area, children play ground and central courtyard.

- + 2 double bedrooms with b/ins main with ensuite
- + Seperate study, internal laundry, air con throughout
- + Open plan kitchen, dining and living area
- + Large entertaining balcony with leafy outlook
- + Security parking, security swipe access throughout

### Upcoming inspection

- Sat 19 Oct 11:00 am to 11:45 am



**Robert Paridis**  
Principal

Laing+Simmons Bondi Junction  
robert.paridis@lsre.com.au  
0412 250 075  
02 8383 1900



SECURITY CAR SPACE

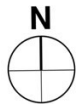
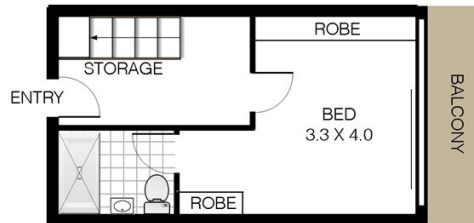

THE INFORMATION CONTAINED IN THIS DOCUMENT HAS BEEN PROVIDED BY THIRD PARTIES. THE AGENCY HAS NOT CHECKED THE INFORMATION AND MERELY PASSES IT ON, NOT HAVING A BELIEF ONE WAY OR THE OTHER AS TO ITS ACCURACY. INTERESTED PARTIES SHOULD MAKE AND RELY UPON THEIR OWN ENQUIRIES.

114/13 Joynton Avenue , Zetland

