



Family townhome featuring dual levels

Awaiting Guide

This dual level 3 bedroom townhouse is sure to tick all the boxes for those looking for that easy-going lifestyle. Located in the popular "Ivanhoe" complex and surrounded by the lush Warriewood Wetlands, this home boasts a private and tranquil setting while still offering convenience.

It delivers a thoughtfully designed floorplan with the 3 bedrooms and full bathroom upstairs and a spacious open plan living and kitchen area downstairs with internal access to the double garage. Enjoy entertaining and relaxing in the sun-lit private courtyard.

- + Spacious kitchen with plentiful storage, electric stovetop, double drawer dishwasher and great bench space
- + Open-plan living & dining extending to a wonderful outdoor entertainment area
- + North facing courtyard with large undercover patio
- + King-size master suite with ensuite, built in and separate north-east balcony
- + Second bedroom with private balcony and built-in wardrobe
- + Full bathroom and large laundry
- + Complex features a heated indoor pool, car wash bay, ample visitor parking
- + Pet friendly (subject to owners corporation approval)
- + Rental Return: \$800 – \$820 per week

Council: \$335 per quarter approx.

Water: \$172 per quarter approx.

Strata: \$1,087 per quarter approx.

*** Disclaimer: We have obtained all information in this document from sources we believe to be reliable; however, we cannot guarantee its accuracy. Prospective purchasers are advised to carry out their own investigations

Amenities

- 2 Garage

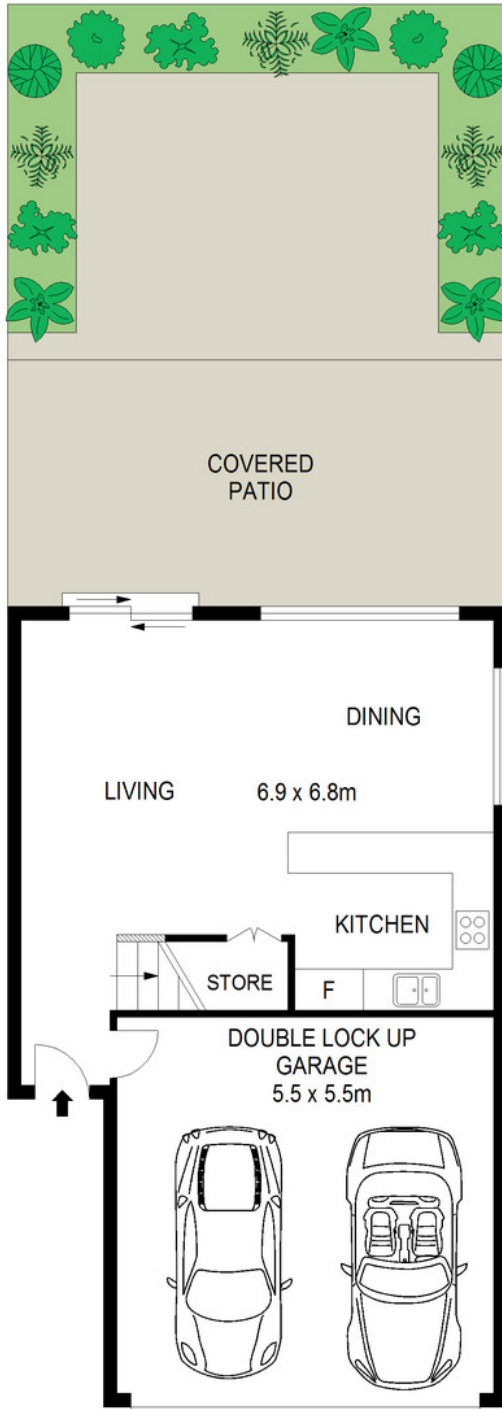

GROUND FLOOR

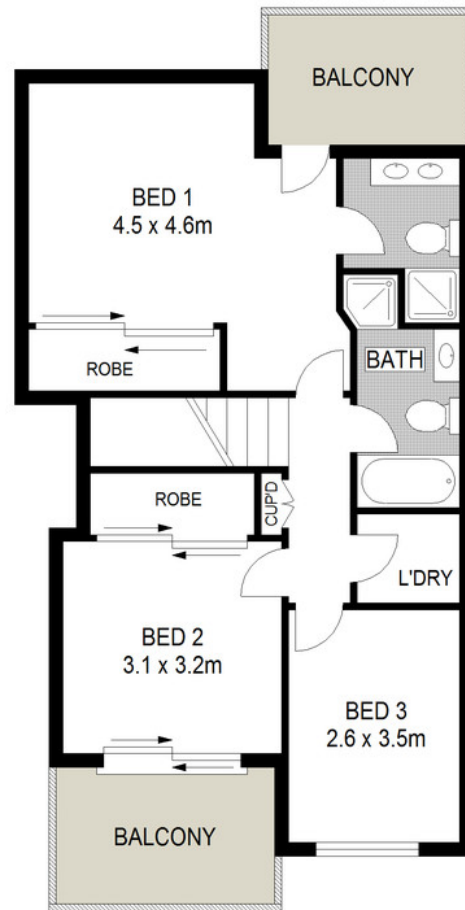

FIRST FLOOR



APPROX : GROSS INTERNAL AREA :- 130 SQM
APPROX : GROSS EXTERNAL AREA :- 39 SQM



Laing+Simmons

All information contained herein is gathered from sources we believe to be reliable. We cannot however guarantee its accuracy and interested parties should make and rely on their own enquiries

