

Contemporary Family Living Steps To Peakhurst Park

\$1,051,800

Built only four years ago, this high-quality home offers bright and contemporary family living. A solid double brick semi-detached design capturing a premium north aspect, the home opens to multiple sunny alfresco spaces and newly upgraded wraparound gardens. In a quiet and leafy pocket 150m from Peakhurst Park, the home is handily placed within a walk of conveniences including Riverwood Plaza shops and train station, St Joseph's Primary and Peakhurst Public School.

- + Three separate living areas offer flexible spaces for the whole family
- + Caesarstone island kitchen with stainless steel appliances & gas
- + Enclosed wraparound lawns feature boxed gardens & veggie patch
- + Open living area extends to an alfresco terrace with extra kitchen
- + Zen garden sitting area with bench seating & tranquil water feature
- + All bedrooms feature built-in robes, four opening to outdoor spaces
- + Large master features a walk-in robe, ensuite & private balcony
- + Main bathroom with a freestanding bath tub & separate shower
- + Automatic garage, ducted air-conditioning, video intercom, alarm
- + Inspection by appointment



Bobbi Trajkovski
Partner

Laing+Simmons St George | Carss Park
bobbi.trajkovski@lsre.com.au
0412 398 102
02 8558 0011



Dimitri Keramea
Partner

Laing+Simmons St George | Carss Park
dimitri.keramea@lsre.com.au
0401 331 397
02 8558 0029

Amenities

- Garage

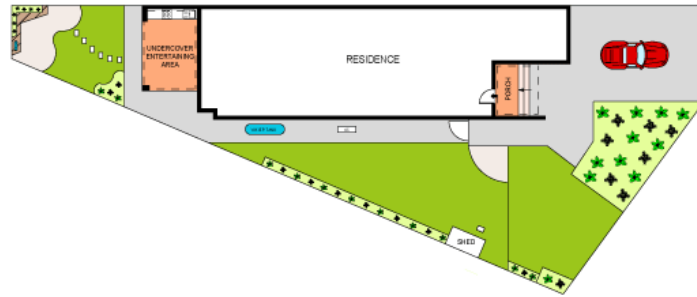

SITE PLAN
(NOT TO SCALE)

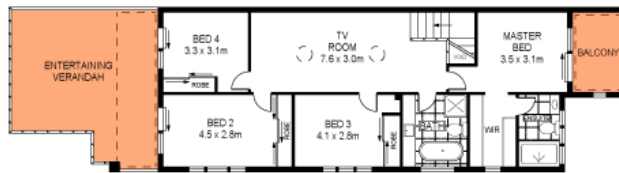

LEVEL ONE



GROUND LEVEL

SCALE (METRES)

PLANS SHOWN ONLY INDICATIVE OF LAYOUT. DIMENSIONS ARE APPROXIMATE.
Ref. No. 69316



58A HEDLEY STREET

RIVERWOOD

