



## Effortless Living!

\$369,950

A well priced lifestyle, this two level spacious residence offers a convenient lifestyle without compromising on space. This property offers two well sized bedrooms, easy maintainable courtyard, a single lock garage & is conveniently located close to schools, shopping centres, swimming pool, public transport and local parks.

- + Two well sized bedrooms
- + Spacious kitchen with plenty of cupboard space
- + Good sized lounge & separate dining room
- + Family bathroom with separate shower and bathtub
- + New carpet & freshly painted upstairs
- + Internal laundry
- + Single lock up garage
- + Great rental return of \$320 per week

For further information please contact our friendly staff on 9673 2200.

Disclaimer: We have been furnished with above information, however, Laing + Simmons gives no guarantees, undertakings or warnings concerning the accuracy, completeness or up-to-date nature of the information provided. All interested parties are responsible for their own independent enquiries in order to determine whether or not this information is in fact accurate.



**Paul Abassi**  
Group Principal

Laing+Simmons St Marys | Ropes Crossing  
paul.abassi@lsre.com.au  
0418 628 138  
02 9673 2200



**Aman Puri**  
Sales Consultant

Laing+Simmons St Marys | Ropes Crossing  
aman.puri@lsre.com.au  
0458 101 050  
02 9673 2200

21/1 Schiller Place, Emerton



Please note:  
 Floorplan measurements are a guide only.  
 All dimensions are approximate in their distance and volume.

Rear

Lower Floor

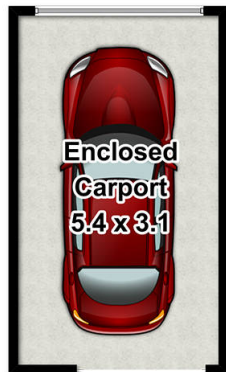

Upper Floor

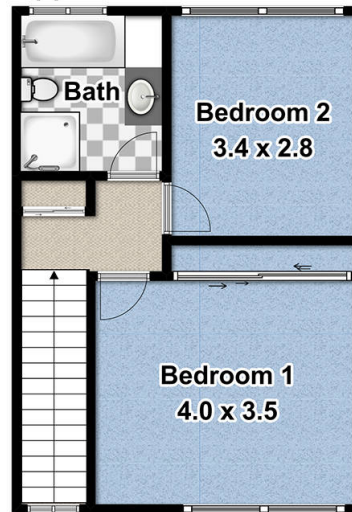
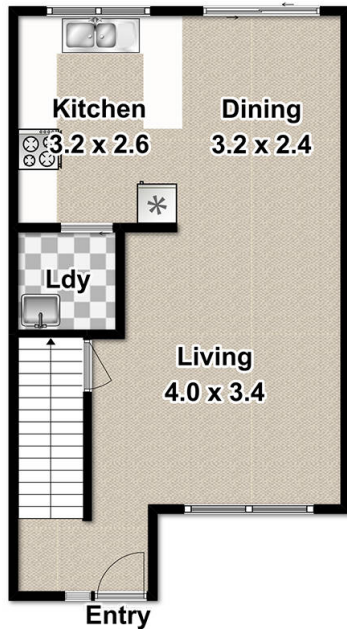

Front



-  2
-  1
-  1



Paul Abassi  
 Ph: 02 9623 7999  
 M: 0418 628 138  
[paul.abassi@lsre.com.au](mailto:paul.abassi@lsre.com.au)

