



Sold At Auction - Grand Family Home

\$1,205,000

From the moment you step in to this enormous two storey owner-built family home, you will be impressed by the size. Set on approximately 577m2 block of land, this property offers 5 bedrooms, 4 bathrooms, timber kitchen with stainless steel appliances and ducted air-conditioning. All the quality inclusions that your family will love and all within easy access to local shops, transport, schools and medical centre.

- 5 large bedrooms all with built-ins
- 4 bathrooms
- Formal lounge/family room/dining room
- Large timber and granite kitchen with gas cooking with dishwasher and stainless steel appliances
- Internal laundry with second kitchen
- Double lock-up garage with internal access
- 4 zone reverse cycle ducted air-conditioning
- Ducted vacuum
- Easy access to local shops, transport, schools and medical centre.
- Land size: 577m2 approximately

Looking for finance approval? We can help you.



Anthony Sassine
Sales Executive

Laing+Simmons Granville
anthony.sassine@lsre.com.au
0411 363 105
02 9637 8111

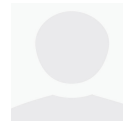

Laing + Simmons
Granville

Amenities

- 2 Garage

310 Blaxcell Street Granville

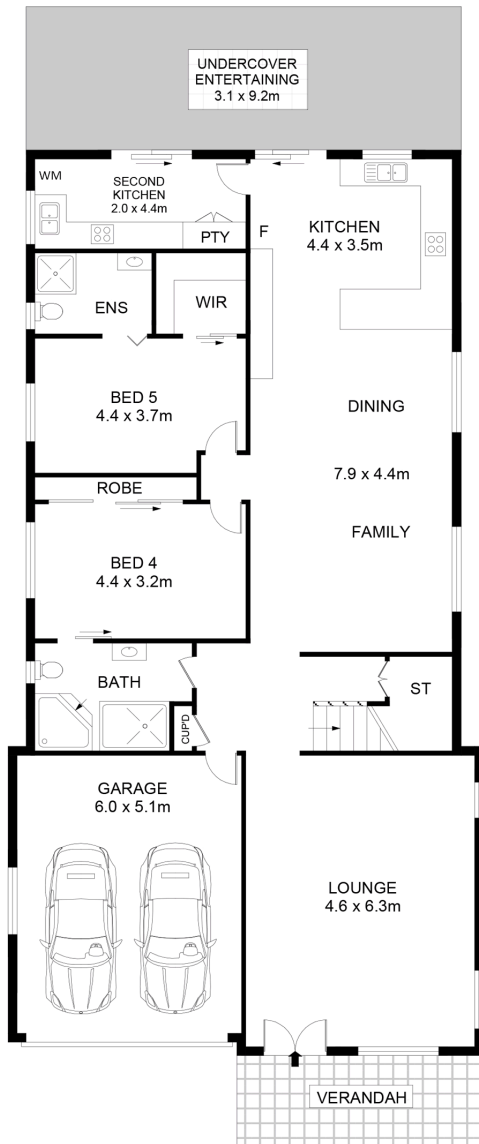

GROUND LEVEL

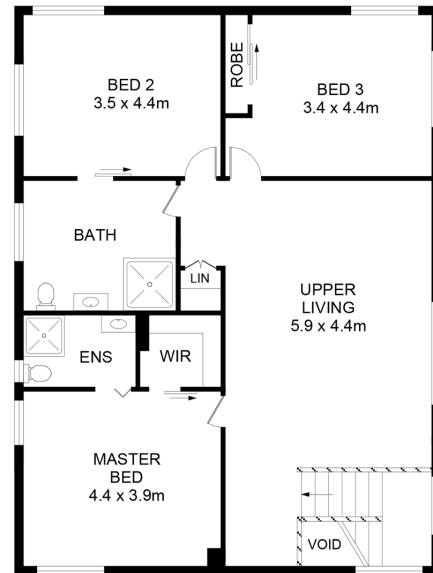

FIRST LEVEL

DISCLAIMER
DIMENSIONS ARE APPROXIMATE AND SHOULD ONLY BE USED AS A GUIDE
THEY ARE NOT TO SCALE AND NO LIABILITY WILL BE ACCEPTED

